



## Mini MFD

## SPECIFICATION SHEET



### DESCRIPTION:

Mini MFD is a compact multi-function display featuring an electronic CAN-bus architecture and platform derived from our standard Direct Data-Bus Instrument (DDBI™) tachometer. It provides critical operating information to the user to ensure optimal performance. Sealed push-buttons offer improved tactile feel. Designed for severe-duty, the unit is configurable via intuitive menu control, with 50 stored parameters.

### FEATURES:

- ▶ LCD, 128 x 96 resolution, viewing area 42 x 29 mm
- ▶ Integrated keypad with 4 tactile switches, sealed
- ▶ Intuitive menu control: Escape, Up, Down, Enter
- ▶ 50 stored standard parameters (per SAE J1939)
- ▶ Amber LED backlighting for LCD
- ▶ White LED backlighting for switches
- ▶ 2 status indicators, LED, amber & red
- ▶ Configurable for digital & analog inputs
- ▶ Switched output capability—controls accessories
- ▶ Password-protected for initial set-up & configuration

### INPUTS/OUTPUTS:

- ▶ 4 configurable digital or analog inputs
- ▶ 1 high-side switch (e.g. to drive buzzer)
- ▶ 1 low-side switch (e.g. to drive a relay)
- ▶ 1 ignition input
- ▶ 1 battery input
- ▶ 1 ground for analog sender
- ▶ 1 CAN channel

### COMMUNICATION LINK:

- ▶ CAN interface, SAE J1939 protocol

### PIN ASSIGNMENTS:

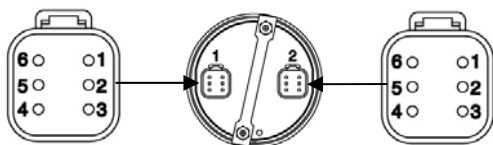

Connector 1: Pin/Function	Connector 2: Pin/Function:
1: Battery (Power Supply)	1: Ignition (Key switch)
2:Ground (Power Supply)	2: Digital/analog 2 (Input)
3:Digital/analog 1 (Input)	3:Digital/analog 3 (Input)
4: CAN+ (J1939 interface)	4: Digital/analog 4 (Input)
5:CAN - (J1939 interface)	5: Analog Ground (Sender)
6:Low-side switch (Driver)	6: High-side switch (Driver)



Derived from Maxima's Direct Data-Bus Instrument (DDBI™) tachometer/speedometer

### ELECTRICAL:

- ▶ System voltage: 12/24V nominal, 9-32 VDC range
- ▶ Electrical protection: Reverse polarity, transients including load-dump, over-voltage & ESD.

### ENVIRONMENTAL:

- ▶ Operating temperature: -30°C to +85°C
- ▶ Storage temperature: -55°C to +85°C
- ▶ Sealing: IP 67; Anti-fog coated safety plastic lens
- ▶ Compliant: SAE standards for vibration & salt spray

### PHYSICAL CHARACTERISTICS:

- ▶ Weight: 0.32 lbs (0.15 kg)
- ▶ Mounting: Panel installation via bracket
- ▶ Same size as standard tachometer (3-3/8" diameter)
- ▶ Engineering resin enclosure, reinforced, UV resistant

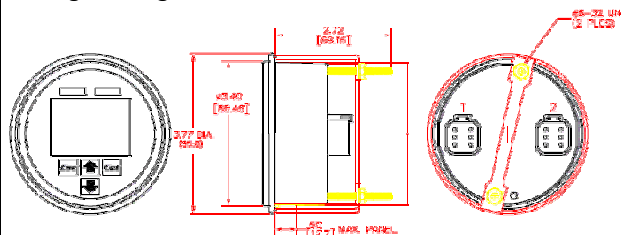

### CONNECTORS:

- ▶ 2 6-pin Deutsch DT Series connectors, sealed (IP 67)
- ▶ Pin-for-pin compatible with competitor's unit (Ask Maxima for more details)

### CONFIGURATION/OPERATION:

Configurable via menu selections. Displays various Performance and Status Pages via one or two lines of text and/or icons. Use "Esc" (Escape), Up, Down or "Enter" to navigate set-ups and choice of screens. Auto-scroll option enables continuous looping. Unit can be set up for English, Spanish or French. Analog input can be configured for resistance or voltage.

YOUR SIX-SIGMA INSTRUMENTATION & CONTROLS PARTNER™